

Made of plastic PA6 GF 30

End and through distributor sockets made of high strength, glass fibre reinforced plastic (PA6 GF 30) with large range of applications. Optionally 1 or up to 3 connection options as well as 2 thread sizes for internal and external threads (cannot be combined). For vertical carrying of media.

Universal distributor socket with up to 6 connection options. Suitable for vertical and/or horizontal carrying of media or the secure connection (avoidance of existing components) of pressure reducer or maintenance device, for example.

All distributor sockets have a durable brass threaded insert, whose shape secures it against rotation and against axial shift due to its shape.

Suitable for media compressed air (ambient temperature -10 °C to 50 °C) or water (ambient temperature 1 °C to 50 °C). Drilling diagram dimensions are identical for all distributor sockets, so a simpler and more flexible exchange between end, through and universal distributor sockets is ensured.

### Caution:

Note that the distributor sockets should not be installed in danger zones. Danger zones are, for example, transport routes, escape routes, etc.

Operating pressure:	max. 15 bar
Ambient temperature compressed air:	-10 °C to 50 °C
Ambient temperature water:	1 °C to 50 °C
Housing:	Glass fibre-reinforced plastic PA6 GF 30
Port:	Brass
Max. tightening torque brass thread:	12 Nm
Max. tightening torque mounting holes:	4 Nm

### End distributor without through-hole thread, PN 15

Art. No.	Type No.	Inlet thread	Through-hole thread	Thread	Connection
112613	EVD12-1	G 1/2 IT	-	G 1/2 IT	1
112614	EVD12-2	G 1/2 IT	-	G 1/2 IT	2
112615	EVD12-3	G 1/2 IT	-	G 1/2 IT	3
112616	EVD34-1	G 3/4 IT	-	G 1/2 IT	1
112617	EVD34-2	G 3/4 IT	-	G 1/2 IT	2
112618	EVD34-3	G 3/4 IT	-	G 1/2 IT	3



EVD12-1



EVD12-2



EVD12-3

### Through distributor with through-hole thread, PN 15

Art. No.	Type No.	Inlet thread	Through-hole thread	Thread	Connection
112619	DVD12-1	G 1/2 IT	G 1/2 IT	G 1/2 IT	1
112620	DVD12-2	G 1/2 IT	G 1/2 IT	G 1/2 IT	2
112621	DVD12-3	G 1/2 IT	G 1/2 IT	G 1/2 IT	3
112622	DVD34-1	G 3/4 IT	G 3/4 IT	G 1/2 IT	1
112623	DVD34-2	G 3/4 IT	G 3/4 IT	G 1/2 IT	2
112624	DVD34-3	G 3/4 IT	G 3/4 IT	G 1/2 IT	3

## Universal distributor with through-hole thread, PN 15

Art. No.	Type No.	Inlet thread	Through-hole thread	Thread	Connection
194135	UVD12-6	G 1/2 IT	G 1/2 IT	G 1/2 IT	4

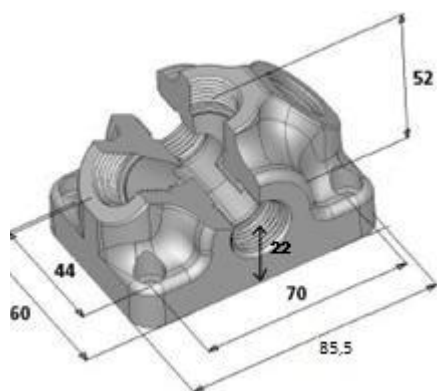

DVD12-3



UVD12-6

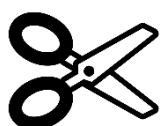

Drillings in the box:  
Ideal plugs: Ø6mm  
Ideal screws: Ø4mm

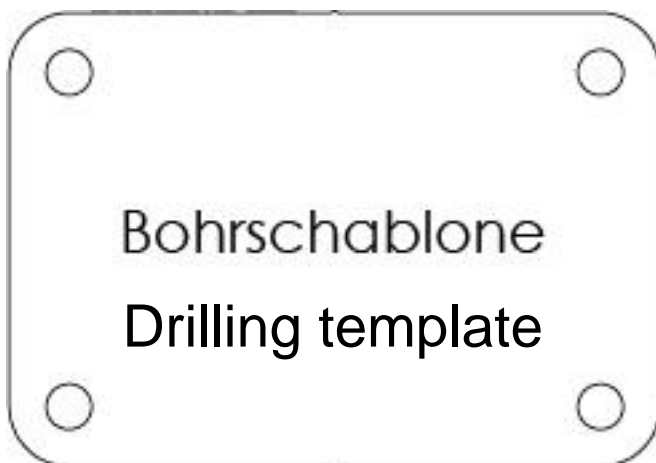

Drilling template for cutting  
out (*original template*):

Ø5.5mm

flat head